

15 January 2021

Norwich, Longwater, William Frost Way

Aldi submit a planning application

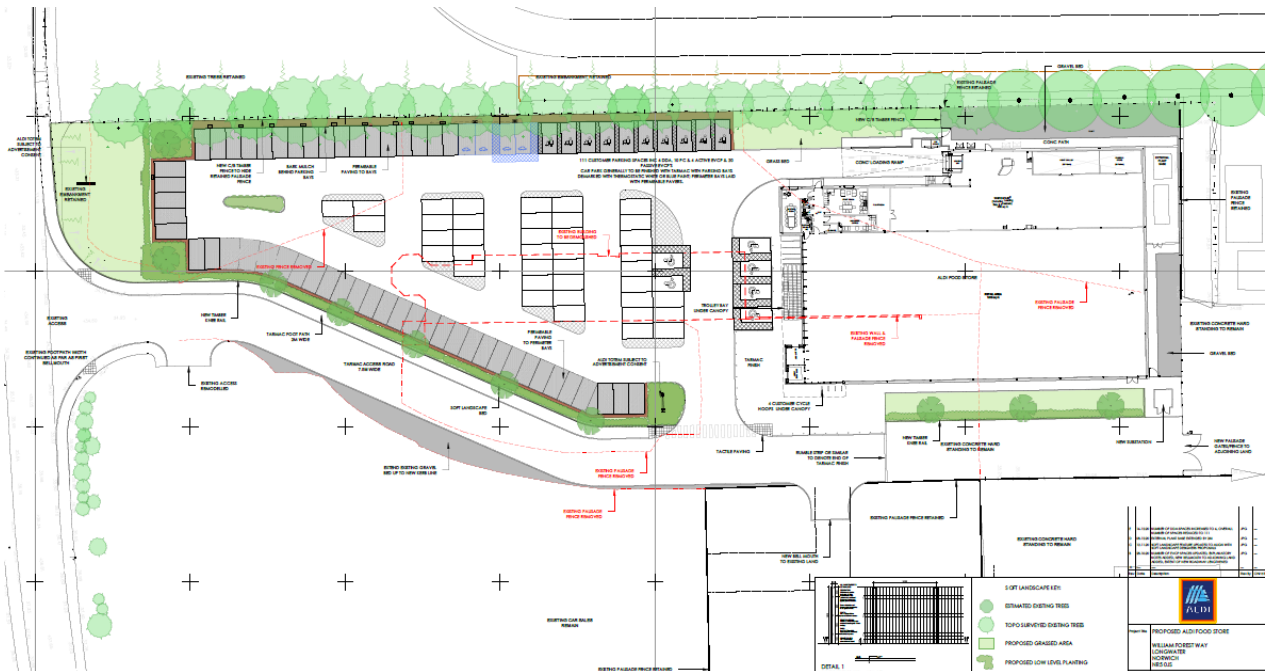

Aldi's planning application for a 1,966 sq m (21,161 sq ft) store with 112 car parking spaces was made on 15 January and has been validated by South Norfolk District Council.

Neil Perrin of MP Real Estate advised Aldi, and Gregory Moore Property advised the landowner, Citygate Developments Ltd, on the conditional purchase, subject to planning.